



The Ballroom, Meshwick Hall Mesh Pond, Downton, Salisbury, Wiltshire,  
SP5 2NQ

£1,395 PCM

Mesh Wick House was originally a Victorian Country House, built in the Dutch style for Captain Beech and his family in 1890, the property being divided in 1975. The accommodation of The Ballroom comprises. Entrance hall with tiled flooring, luxury fitted kitchen including gloss black fronted units, 5 ring stainless steel gas hob, splash back and cooker hood, double electric oven, wine cooler, freestanding fridge and freezer, two feature porthole windows, utility with plumbing for washing machine, wall mounted gas fired central heating boiler, WC with wash hand basin and WC. A most impressive drawing room with woodblock flooring and wainscot paneling, large bay window, french doors to outside, feature ornamental fireplace, two staircases, one to each bedroom. Conservatory with tiled flooring, work surface and wall units, air conditioning unit, and wine cooler. The first floor is accessed from the two staircases from the drawing room. Staircase one to master bedroom with turret, laminate wood effect flooring, and opening to the dressing room. Luxury en suite bathroom, with jacuzzi bath, WC, inset wash hand basin, shower cubicle, and thermostatic shower. Staircase two to bedroom two. and en suite bathroom with en-suite bathroom with bath, thermostatic shower and screen over bath. Outside there is a arge enclosed courtyard, two parking spaces. Gas fired central heating. UNFURNISHED. Not suitable for pets. Potentially long term let

### Ground Floor

Approx. 92.0 sq. metres (989.8 sq. feet)

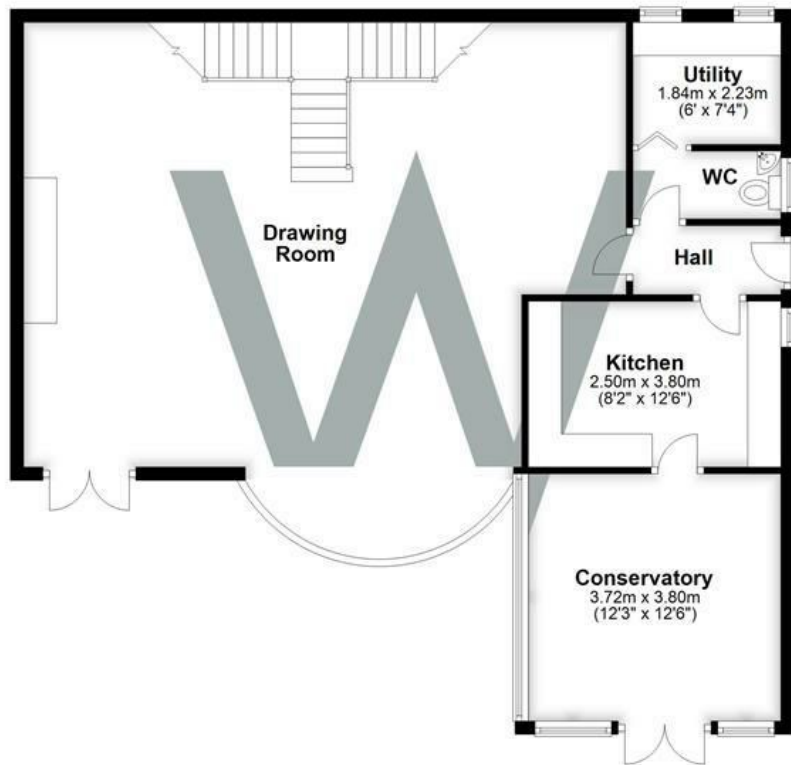

### First Floor

Approx. 78.7 sq. metres (846.7 sq. feet)

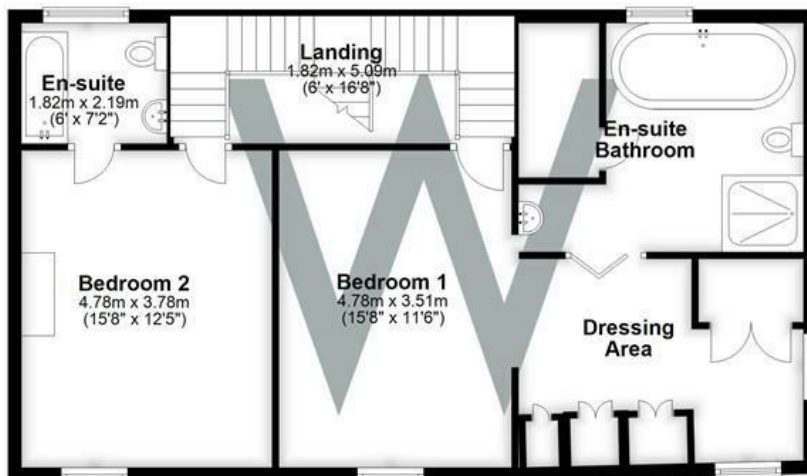

Total area: approx. 170.6 sq. metres (1836.5 sq. feet)

#### Energy Efficiency Rating

	Current	Potential
Very energy efficient - lower running costs		
(92 plus) <b>A</b>		
(81-91) <b>B</b>		<b>85</b>
(69-80) <b>C</b>		
(55-68) <b>D</b>	<b>63</b>	
(39-54) <b>E</b>		
(21-38) <b>F</b>		
(1-20) <b>G</b>		
Not energy efficient - higher running costs		
<b>England &amp; Wales</b>	EU Directive 2002/91/EC	

**WHITES**  
Castle Chambers, 47 Castle Street,  
Salisbury, Wiltshire, SP1 3SP  
01722 336422  
www.hwwhite.co.uk  
residential-sales@hwwhite.co.uk

